

BARRE PIENE A FILETTATURA CONTINUA

B450/540 diam. 20 - 40

Sinistrorsa, laminata a caldo

CONTINUOUS THREADED BARS - CT BAR

Hot rolled, ribbed – left hand thread

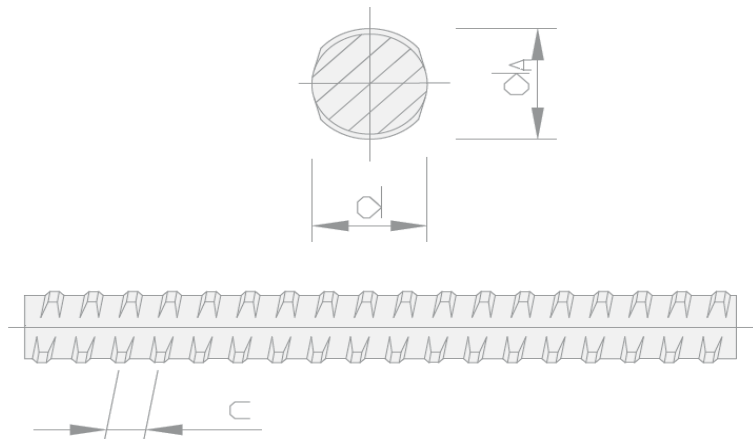

d mm	20	25	28	32	40
d _A mm	23	29	32	36	45
c mm	10	12,5	14	16	20
f _y /f _t /A ₁₀ ¹⁾	450 N/mm ²		540 N/mm ²	≥ 7,50%	
F _y (F _{0,2}) kN	141	221	277	362	565
F _t kN	169	265	333	434	678
A mm ²	314	491	616	804	1256
G kg/m	2,46	3,85	4,84	6,31	9,86

f_y = tensione di snervamento minima / minimum yield stress

f_t = tensione di rottura minima / minimum break stress

F_y = carico di snervamento minimo / minimum yield load

F_t = carico di rottura minimo / minimum break load

A₁₀ = allungamento a rottura su base 10 diametri / extensibility on 10 diameter bases

A = area / area